



WARNINGS / CAUTIONS

FOR YOUR SAFETY AND TO ASSURE THAT THIS PRODUCT PERFORMS AS IT WAS DESIGNED PLEASE READ ENTIRE MANUAL INCLUDING ALL WARNINGS & CAUTIONS BEFORE USING THIS PRODUCT

IMPORTANT INFORMATION

Release of Liability and Assumption of Risk

BY USING THIS PRODUCT THE USER CONFIRMS AND ACKNOWLEDGES THAT HE OR SHE UNDERSTANDS AND AGREES TO THE FOLLOWING CONDITIONS AND TERMS OF USE.

THE RISK OF INJURY FROM THE ACTIVITIES INVOLVED IN THE USE OF TRAILSKATE™ ALL-TERRAIN SKATES IS SIGNIFICANT, INCLUDING THE POTENTIAL FOR PERMANENT PARALYSIS AND DEATH, AND WHILE PARTICULAR RULES, SAFETY EQUIPMENT, AND PERSONAL DISCIPLINE MAY REDUCE THIS RISK, THE RISK OF SERIOUS INJURY DOES EXIST. THE USER KNOWINGLY AND FREELY ASSUMES ALL SUCH RISKS, BOTH KNOWN AND UNKNOWN, EVEN IF ARISING FROM THE NEGLIGENCE OF THE RELEASEES OR OTHER, THE USER KNOWINGLY ASSUMES FULL RISK AND RESPONSIBILITY FOR THE USER'S PARTICIPATION.

THE USER, ON BEHALF OF USER'S SELF, HEIRS, ASSIGNEES, PERSONAL REPRESENTATIVES, AND NEXT OF KIN, HEREBY RELEASES AND HOLDS HARMLESS GATESKATE, INC., ITS OFFICERS, OFFICIAL AGENTS, SPONSORS, ADVERTISERS, RESELLERS, DISTRIBUTORS AND IF APPLICABLE, OWNERS, WITH RESPECT TO ANY AND ALL INJURY, DISABILITY, DEATH, LOSS OR DAMAGE TO PERSON OR PROPERTY, WHETHER ARISING FROM THE NEGLIGENCE OF THE RELEASEES OR OTHERWISE.



CAUTION

ALWAYS WEAR PROTECTIVE GEAR WHEN USING THIS PRODUCT
HELMET, KNEE PADS, ELBOW PADS, AND WRIST GUARDS

TRAILSKATE™
ALL-TERRAIN SKATES

Manufactured Under United States and International Patents

U.S. PATENT NUMBER 5,251,934

U.S. PATENT NUMBER 4,943,075

Copyright © 2002 GateSkate, Inc. All Rights Reserved. GateSkate and the GateSkate logo are registered trademarks of GateSkate, Inc., 2655 Einstein Avenue, Richland, WA 99352 USA. TrailSkate and the TrailSkate logo are trademarks of GateSkate, Inc. All other product names are trademarks or registered trademarks of their respective owners.

GATESKATE™

WELCOME... TO THE WORLD OF **TRAILSKATE™** ALL-TERRAIN SKATING

All-terrain skating is one of the fastest growing sports in the world today. It is comparable to many other thrill sports such as mountain biking, skateboarding, and skiing. The **TrailSkate™** all-terrain skate represents an evolutionary leap in human powered sports. It is truly the mountain bike of the skating world. **TrailSkate™** all-terrain skates dare to go where no in-line skate has ever gone before. They are easy to ride. And... they are a whole lot of fun.

TrailSkate™ all-terrain skates - designed and manufactured by GateSkate, Inc. - are a revolutionary advance in skate design. They are the only in-line skate manufactured with a patented hand-operated hydraulic brake system that allows users to easily control skate speed and stop efficiently. And, because of their lower center of gravity and larger pneumatic tires, **TrailSkate™** all-terrain skates are easier to use than traditional in-line skates.

The sport of all-terrain skating offers universal appeal, it's fun, easy to learn and it is an excellent exercise for men and women of all ages. It's a great family activity! Whether you are a novice or expert skater, **TrailSkate™** all-terrain skates allow you to take it to your own level. Come and enjoy the fun and freedom of **TrailSkate™** all-terrain skating.

GateSkate, Inc.
2655 Einstein Avenue
Richland, WA 99352
phone: (509) 371-0726
email: support@gateskate.com
www.gateskate.com



PARTS OF YOUR TRAILSKATE™

There are eight (9) major components to your *TrailSkate*™ all-terrain skates:

1. SKATE CHASSIS (PLATFORM)
2. ADJUSTABLE SKATE BINDING
3. BINDING BUCKLE
4. FRONT WHEEL
5. REAR WHEEL
6. BRAKE ASSEMBLY
7. BRAKE CABLE
8. BRAKE HANDLE ASSEMBLY
9. WAIST BELT FOR THE BRAKE LINE & BRAKE HANDLE ASSEMBLY

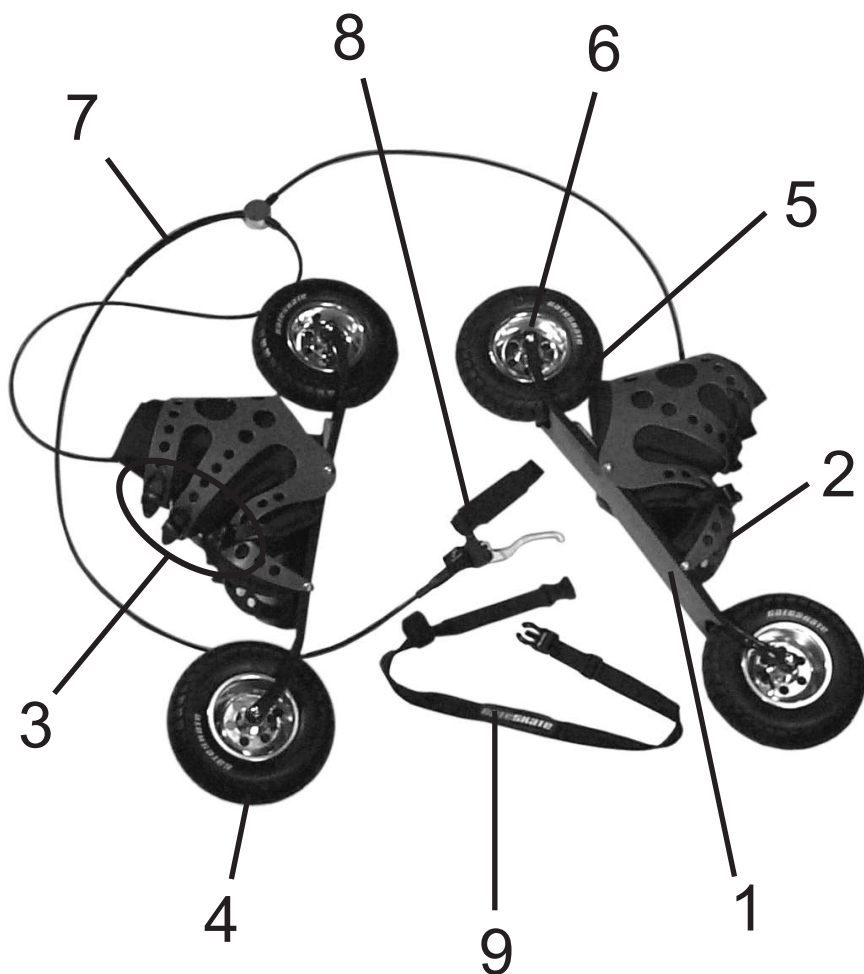

Figure 1

INTRODUCTION TO *TRAILSKATE*™ ALL-TERRAIN SKATING

If you can ride a bicycle or walk for extended periods of time, you probably have all of the balance and ability you need to enjoy riding your *TrailSkate*™ all-terrain skates. If you have ever skated or skied, you will adapt quickly to your *TrailSkate*™ all-terrain skates. Remember... stay within your comfort zone and have fun.

To enjoy your *TrailSkate*™ all-terrain skates safely it is essential that you read this entire manual. For your safety always wear and use protective gear including: helmet, kneepads, elbow pads and wrist guards. Learn at your own pace and use common sense and courtesy when you skate.

Remember that *TrailSkate*™ all-terrain skates are not toys. They are serious pieces of transportation/athletic equipment that should be treated with the same care and attention as bicycles.

All-terrain skating is an inherently dangerous activity, which can result in serious debilitating injuries or even death. You, the all-terrain skater, are the only one who can reduce these inherent risks by always wearing full protective gear and, more importantly, maintaining control at all times.



CAUTION

ALWAYS WEAR PROTECTIVE GEAR WHEN USING THIS PRODUCT
HELMET, KNEE PADS, ELBOW PADS, AND WRIST GUARDS



WARNING

BEFORE STANDING OR RIDING: SQUEEZE THE BRAKE HANDLE A FEW TIMES TO BLEED EXCESS AIR FROM THE BRAKE LINES - **ALWAYS** TEST THE BRAKES BY FIRMLY DEPRESSING THE LEVER ON THE HAND BRAKE. THE REAR WHEELS OF YOUR *TRAILSKATE*™ ALL-TERRAIN SKATES SHOULD NOT ROLL OR MOVE WHEN FIRM PRESSURE IS APPLIED TO THE BRAKE LEVER. IF THE BRAKES DO NOT WORK AS SPECIFIED, **DO NOT USE THIS PRODUCT.**

HYDRAULIC BRAKE OPERATION

The following is important safety information about the *TrailSkate™* all-terrain skate hand-operated hydraulic brake system:

Always check the brake system before using your skates. Squeeze the brake handle and make sure the brake pads have full contact with the wheel hubs. If the brakes are working correctly, it should be difficult to turn the rear wheels by hand with the brake lever depressed.

Check the brake system and make sure the brake hubs are clean and free of debris, and that there are no hydraulic fluid leaks in the brake lines or fittings.

The brake handle is designed with a reservoir tank that allows you to bleed excess air out of the hydraulic lines. Whenever the brake lever on the brake handle is turned upside down or positioned below the brake drum located in the rear wheel hubs, the brake system may get air bubbles inside the brake lines. If the skates are used in this condition, there is a danger that the brakes may not operate.

To insure that the brakes are working properly, always depress (squeeze) the brake lever a few times before skating. Hold the master brake lever in your hand above your waist with the handle pointing up. Pumping the brake lever will force any excess air bubbles out of the system through the reservoir bleed hole located below the brake handle. Pump the brake lever five (5) or more times, or until the brake lever provides firm resistance in your hand and the rear wheels do not roll with the brake lever depressed.



Figure 2

WARNING

BEFORE STANDING OR RIDING: SQUEEZE THE BRAKE HANDLE A FEW TIMES TO BLEED EXCESS AIR FROM THE BRAKE LINES - **ALWAYS** TEST THE BRAKES BY FIRMLY DEPRESSING THE LEVER ON THE HAND BRAKE. THE REAR WHEELS OF YOUR *TRAILSKATE™* ALL-TERRAIN SKATES SHOULD NOT ROLL OR MOVE WHEN FIRM PRESSURE IS APPLIED TO THE BRAKE LEVER. IF THE BRAKES DO NOT WORK AS SPECIFIED, **DO NOT USE THIS PRODUCT.**

TRAILSKATE™

ALL-TERRAIN SKATES

SKATING BASICS

Putting on your *TrailSkate™* all-terrain skates is easiest from a sitting position while using a chair or bench.

1. With your skates in front of you, make sure your brake lines are not tangled and are placed behind the skates.
2. Buckles on the adjustable skate binding should face to the outside of the foot.
3. Brake mechanisms on the rear wheels should face to the inside of the skates.



Figure 3

4. Undo the buckles on the bindings and the Velcro™ fasteners on the inner foam liner.
5. Spread the binding and liner open and slip the heel of the shoe into the binding from the front.
6. Slide the heel of the shoe snugly into the back of the binding.



Figure 4

TRAILSKATE™ ALL-TERRAIN SKATING BASICS

- Secure the Velcro™ fasteners on the inner foam liner so it fits firmly around the foot and the ankle.

- Secure the buckles on the binding starting with the lower strap and ratchet the buckle. Then work your way up the remaining two straps. The fit should be snug but comfortable while preventing shoe movement and slippage.

NOTE: The outside of binding (buckle side) should overlap the inside of the binding (strap side).

(Repeat the process for the other foot.)

- Secure the brake line on the back of the waist belt with the Velcro fastener.

NOTE: Taller skaters should attach the belt at the upper most portion of the brake line Velcro™ located above the 'Y' junction.

Shorter skaters should attach the belt at a portion of the brake line Velcro™ closer to the 'Y' junction.

BRAKE LINE & WAIST BELT ASSEMBLY

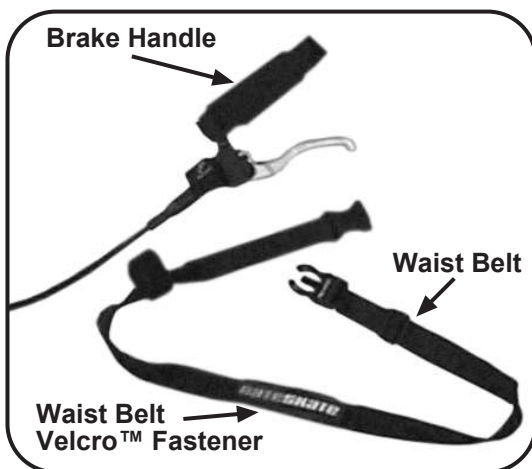

Figure 5

ATTACHING WAIST BELT TO BRAKE LINE

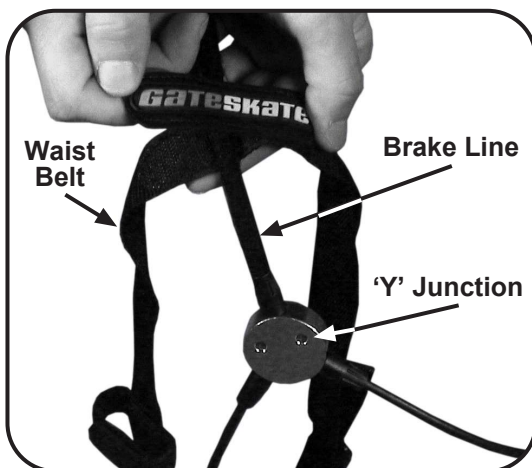

Figure 6



CAUTION

IF A SECURE, COMFORTABLE FIT CANNOT BE ACHIEVED
DO NOT USE THESE SKATES.

TRAILSKATE™ ALL-TERRAIN SKATING BASICS

10. Now secure the waist belt around the waist.

NOTE: Your waist belt is equipped with a Velcro™ fastener for the Brake Handle. This allows for hands free skating or use with ski poles.

11. Finally use the lower straps on the knee guards to secure the brake lines behind the legs.
12. Now you are ready to stand up on your skates. Depress and hold the brake, push your weight forward and stand up.



Figure 7

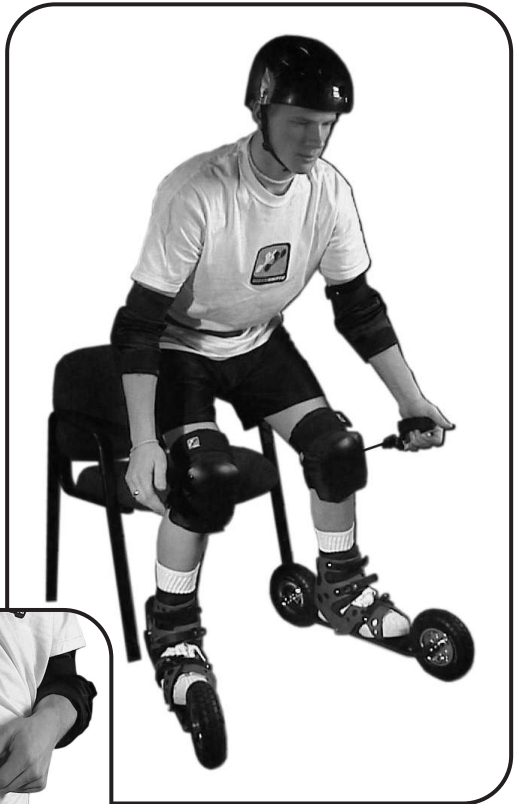

CAUTION

DO NOT PLACE YOUR BODY WEIGHT OVER THE BACK WHEELS OF YOUR SKATES. ALWAYS KEEP YOUR KNEES AND NOSE OVER YOUR TOES. PLACING YOUR WEIGHT OVER THE REAR WHEELS MAY CAUSE YOU TO FALL BACKWARDS.

COMING TO A STANDING POSITION FROM THE GROUND

1. Roll over onto one side. (*Figure 8 – Step 1*)
2. Push the upper leg forward. Place the wheels of the skate on the upper leg on the ground out to one side. (*Figure 8 – Step 2*)
3. Roll onto the knee of the lower leg.
4. With the brake lever depressed - pick up the skate on the lower leg, swing the skate forward and place the wheels on the ground while supporting yourself with your arms. The skates should be pointing in the same direction approximately a shoulder width apart. (*Figure 8 – Step 3*)
5. When you feel stable and have found your balance rise to a standing position. Release the brake when you are ready to skate. (*Figure 8 – Step 4*)

NOTE: practice this maneuver until you are comfortable with the movement.

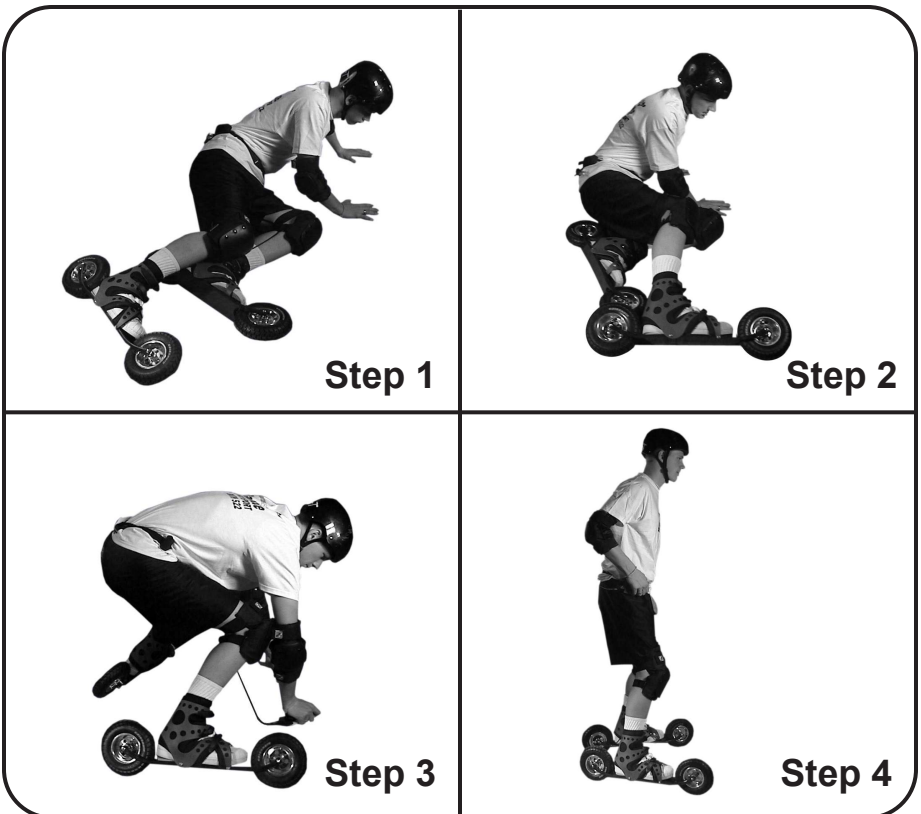

Figure 8

BASIC SKATING INSTRUCTIONS

1. THE SKATING POSITION:

The proper skating position is achieved by standing in an erect position while leaning slightly forward with the knees slightly bent. Remember knees forward body erect (Knees and nose over your toes). Practice this position with the brakes depressed until you are comfortable standing in this position.



Figure 9



CAUTION

KEEP KNEES SLIGHTLY TOGETHER BEARING WEIGHT TO THE INSIDE EDGE OF THE WHEELS. DO NOT ROLL SKATES TO THE OUTSIDE EDGE OF THE WHEELS. ROLLING THE SKATES TO THE OUTSIDE EDGE OF THE WHEELS CAN CAUSE YOU TO FALL.

2. SIDE STEP MANEUVER:

With the skates parallel, lift one skate up and extend it outward to one side. Lift the other skate up and position it next to the stepping skate. Keep the brakes depressed during this maneuver.

Work back and forth with the brakes depressed until you are comfortable with this maneuver.



Figure 10

BASIC SKATING INSTRUCTIONS

3. THE STATIC TURN:

With the brakes depressed, lift the front wheel of one skate, rotate it a few degrees in the direction of the turn you wish to make, and place your weight on this skate. Lift the other skate and bring it parallel to the first skate so that both skates are pointing in the same direction. Continue stepping the skates around until you have completed the turn. This is the basic turning maneuver. Practice stepping and turning with the brakes depressed until you are comfortable performing this maneuver.



Figure 11

4. “V” OR SPLAYED POSITION:

In a standing position, make a ‘V’ shape with the skates. The front wheels of the skates should be 12” to 18” apart and the rear wheels should be closer together. This is a basic position for walking and skating on your **TrailSkate™** all-terrain skates.



Figure 12

BASIC SKATING INSTRUCTIONS

5. WALKING THE SKATES:

With the brakes depressed, put your skates in a “V” or splayed position. Slowly walk forward by lifting and moving one skate forward and then the other. Continue this movement with the brakes depressed until you are comfortable walking on your *TrailSkate*™ all-terrain skates.

6. BRAKING:

Starting at the bottom of a slight hill, get in a side step position and while keeping the brakes depressed, side step part way up the hill and stop. Make a Static Step Turn (See Step 4) while keeping the brakes depressed and point the skates down hill. Very slowly release the brakes until you begin moving and hold the brake mechanism there. Roll for a short distance while controlling your speed with the brakes, and then slowly depress the brake handle until you stop. Note correct body position: Knees are forward and the body is erect.

WARNING

WET BRAKES CAN GRAB AND/OR SLIP WHEN BRAKING. IF YOU SUSPECT THAT THE BRAKE ASSEMBLY MAY BE WET, USE EXTRA CAUTION WHEN DEPRESSING THE BRAKE HANDLE ASSEMBLY. USE LESS PRESSURE AND BRAKE MORE SLOWLY UNTIL THE BRAKES DRY.

7. ADDUCTING (SKATING IN PLACE):

While on a flat area, with the brakes depressed, splay (“V”) your skates slightly. Lift one skate, lean slightly to that side and swing the skate out to the side, place it on the ground and shift your weight onto that skate. Now lift the unweighted skate and bring it beside the weighted skate. Repeat this movement in the opposite direction. Continue this maneuver, moving the skates and your position smoothly from side to side until you feel comfortable with this movement. This motion is called ‘Adducting’ and it is the basic maneuver for skating. Note the weight is forward at the knees and the body is erect. Practice this maneuver until you are comfortable with the ‘Adducting Motion’.

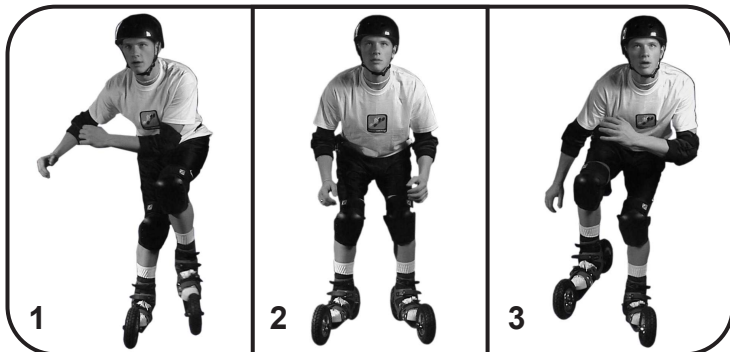

Figure 13

BASIC SKATING INSTRUCTIONS

8. SKATING:

With the brakes depressed, start walking forward. Slowly release the brakes while walking forward.

Note: You will start to roll forward. Keep walking (rolling) forward with the skates in a splayed (“V”) position. Recall the ‘Adducting Motion’. Push off with the weighted skate and shift your weight to the forward skate, then bring the unweighted skate next to the weighted forward skate. Repeat this motion shifting your weight from skate to skate while moving forward...pushing and gliding from skate to skate.

Again, push with the back foot (weighted skate) and roll forward on the front skate. Shift your weight to the forward skate. Weight goes from one skate to the other. Bring the skates together. Weight is on one skate at a time. Weight goes from one skate to the other in a gliding motion. Rotate the weight from the back skate to the front skate and bring the back skate forward. Continue the motion gliding and pushing from skate to skate.

9. PERFORMING THE STEP TURN WHILE MOVING:

We discussed the ‘Static Turn’ with the brakes depressed in ‘Step 3’. In this maneuver you will perform the step turn while moving. Start by skating forward on a flat surface using the ‘Adducting Motion’ described in ‘Step 7’. To initiate the turn, lift the front wheel of the inside skate and step around towards the direction of the turn. Continue skating forward and alternately lift the front wheel of the inside skate, stepping it around and bringing the outside skate up parallel to the inside skate, until the turn is complete. Practice this maneuver until you are completely comfortable making turns while moving forward. Practice right and left turns.

10. USING SKI POLES:

You will find that ski poles offer a tremendous advantage for off-road skating and for going up the steeper slopes. There are two basic ski pole maneuvers:

a) DOUBLE POLLING WITHOUT SKATING.

With skates parallel and pointing forward, from the basic skating position (body erect, knees forward), lean slightly forward, plant both pole tips in front and to the outside of the front wheels of the skates. Simultaneously use both poles to pull your momentum forward. As you move forward of the point that you planted your poles, continue your momentum by pushing the poles behind you. Repeat this motion to continue moving yourself forward. Plant...pull....push.
Plant...pull....push.

b) DOUBLE POLLING WHILE SKATING.

Use the ‘Adducting Motion’ while skating forward and double pole as described above.



CAUTION

WHEN USING SKI POLES, ALWAYS KEEP THE POLES TO THE OUTSIDE OF THE SKATES

RULES OF THE ROAD

TRAIL ETIQUETTE AND BASIC SAFETY:

When skating on trail systems with pedestrians, other skaters, bicycles, etc., skate on the right and pass on the left. When overtaking others on the trail announce your intentions to pass by saying something like "Passing on your left!" This is a common courtesy that will allow people to safely move to the right to allow you more room to pass. If you are using poles, be sure to bring them in close to your body when you are passing traffic or meeting oncoming traffic so that you don't accidentally hit someone with your poles.

THINGS TO REMEMBER

1. ALWAYS YIELD TO PEDESTRIANS
2. OBEY ALL TRAFFIC REGULATIONS AND LAWS
3. NEVER SKATE ON HIGHWAYS
4. AVOID VEHICULAR TRAFFIC & CONGESTED AREAS
5. SKATE UNDER CONTROL AT ALL TIMES
6. WATCH OUT FOR HAZARDS
7. ALWAYS WEAR PROTECTIVE GEAR WHEN USING THIS PRODUCT
8. KNOW AND RESPECT BIKE LANE AND TRAIL RULES & REGULATIONS

BINDING ADJUSTMENT FOR WIDE AND NARROW SHOE SIZES

TrailSkate™ all-terrain skate bindings can be adjusted to accommodate wide and narrow shoe widths. To change the adjustment:

1. Remove the screw in the front strap of the binding from the chassis and reposition it to either the outside or inside hole in the binding strap.
2. For narrow shoe widths place the screw in the hole furthest from the end of the strap and tighten the strap securely to the chassis.
3. For wide shoe widths place the screw in the hole closest to the end of the strap and tighten the strap securely to the chassis.

FINAL WORDS

1. SKATE SMART!!
2. SKATE SAFELY!!
3. SKATE UNDER CONTROL!!
4. ALWAYS CONTROL YOUR SPEED BY USING YOUR BRAKES WHEN GOING DOWNHILL!!
5. BEGINNERS ARE ADVISED TO AVOID STEEP HILLS!!

ALWAYS REMEMBER TO SKATE SAFE AND HAVE FUN!

TRAILSKATE™

ALL-TERRAIN SKATES

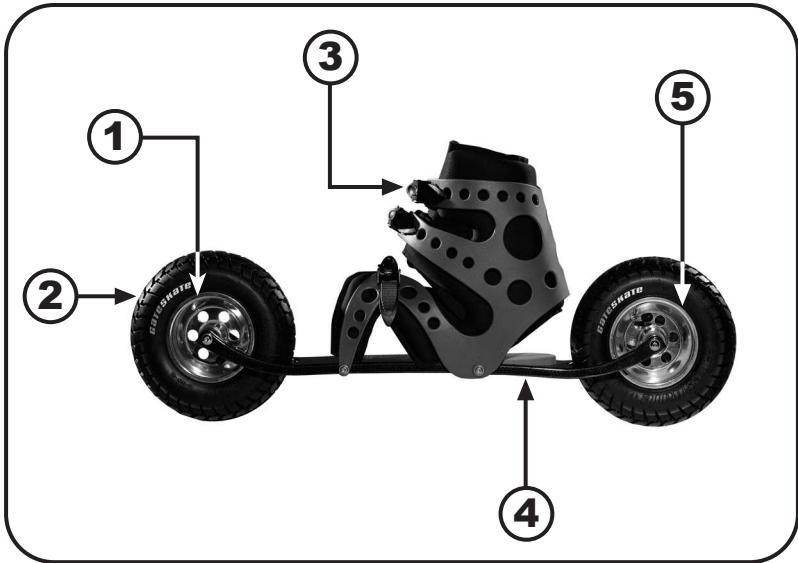

Figure 14

FEATURES

1. Precision molded lightweight aluminum wheels.
2. 8-inch (200mm) high-pressure pneumatic tires (similar to mountain bike tires) provide a smooth ride on rough surfaces.
3. Clamshell boot-binding system fits easily over the user's shoes and is quickly secured with independent ratcheting binding latches and straps for comfort and stability.
4. Precision crafted flexible composite chassis provides a lightweight ski-like platform with a low-center of gravity delivering greater stability than traditional in-line skates.
5. One hand stopping power (using a single lever that simultaneously actuates the hydraulic drum brakes located in the rear wheel of each skate) allows users to easily control speed and stop efficiently.

CHECKLIST

ALWAYS CHECK THE FOLLOWING BEFORE SKATING:

1. Check the brakes...test by activating the brake lever. The rear wheels should be difficult to turn by hand with the brake handle depressed.
2. Check the brake pads and hubs and make sure they are clean and free of dirt and debris.
3. Brake check - spin rear tires and make sure the brake shoes are not hitting the brake hub.
4. Depress the brake lever and make sure the brake pads press firmly against the brake hubs.
5. Check the rear wheels for any leaks, damage or foreign matter that may impede stopping. If brakes do not work as specified, do not use this product.
6. Check tire pressure: 80-psi maximum tire pressure. High pressure reduces friction and allows you to go faster. Beginners may want to lower the tire pressure to go slower.
7. Check the buckles and straps of the ratchet binding system.
8. Check all screws and fittings. Use the supplied tools to tighten loose screws.
9. Check all bindings (buckles, straps and pads).
10. Check to insure the belt, brake handle, and brake handle strap are in good condition and working properly.
11. Spin all tires to insure concentricity and balance.



WARNING

CHECK ALL SCREWS AND FITTINGS BEFORE SKATING. USE THE SUPPLIED TOOLS TO TIGHTEN LOOSE SCREWS OR FITTINGS. IF ANY SCREWS OR FITTINGS ARE DAMAGED OR **CANNOT** BE FASTENED SECURELY, **DO NOT USE THIS PRODUCT.**

CUSTOMER SERVICE / PRODUCT SUPPORT

TO PROVIDE YOU WITH THE BEST AND FASTEST POSSIBLE CUSTOMER SERVICE AND/OR PRODUCT SUPPORT, THE FOLLOWING INFORMATION IS PROVIDED TO ASSIST YOU.

In the unlikely event that you have a problem with your **TrailSkate™** all-terrain skates, please do the following:

1. Contact the store or retailer where you purchased your skates.
2. Check the GateSkate Web site for the latest product support information – <http://www.gateskate.com>
3. Email support@gateskate.com
4. Mail or telephone:

GateSkate, Inc.
Corporate Offices
2655 Einstein Ave.
Richland, WA 99352
USA
phone: 800.936.5330
phone: 509.371.0726
fax: 425.984.9790

GateSkate International Office
Rambla Catalunya, 121, (2-3)
08008 BARCELONA
SPAIN
phone: +34 93 237 70 55
fax: + 34 93 237 27 33

NOTE: Please read the product warranty on the last page of this Owner's Manual for specific details on how to obtain warranty performance.

LIMITED WARRANTY FOR GATESKATE *TrailSkate*™

GATESKATE, INC. WARRANTS *TRAILSKATE*™ ALL-TERRAIN SKATES AGAINST DEFECT IN MATERIAL AND WORKMANSHIP. THE SKATE PLATFORMS AND ALL OTHER PARTS AND COMPONENTS ARE WARRANTED FOR 90-DAYS FROM THE DATE OF FIRST RETAIL PURCHASE. WARRANTY IS NOT TRANSFERABLE AND IS EFFECTIVE ONLY IF THE *TRAILSKATE*™ AND WARRANTY SERVICE IS PERFORMED BY AN APPROVED GATESKATE FACTORY SERVICE CENTER OR BY AN AUTHORIZED *TRAILSKATE*™ SERVICE CENTER.

WHAT IS COVERED

DURING THE PERIOD OF LIMITED WARRANTY, THE GATESKATE FACTORY SERVICE CENTER OR ANY AUTHORIZED *TRAILSKATE*™ RETAIL DEALER WILL EITHER REPAIR OR REPLACE ANY PART PROVED TO BE DEFECTIVE IN MATERIAL OR WORKMANSHIP.

HOW TO OBTAIN WARRANTY PERFORMANCE

TO OBTAIN WARRANTY PERFORMANCE, PRESENT A COPY OF THE BILL OF SALE SHOWING DATE OF PURCHASE TO THE AUTHORIZED *TRAILSKATE*™ SERVICE CENTER.

TRANSPORTATION COSTS

TRANSPORTATION COSTS TO THE GATESKATE FACTORY SERVICE CENTER OR AUTHORIZED *TRAILSKATE*™ SERVICE CENTER MUST BE PREPAID BY THE PURCHASER. IF GATESKATE, INC. CONFIRMS THE EXISTENCE OF A DEFECT, GATESKATE, INC. WILL PAY RETURN SHIPPING. IF WARRANTY IS NOT APPLICABLE, THE PRODUCT WILL BE RETURNED FREIGHT COLLECT. (TO AVOID UNNECESSARY TRANSPORTATION AND INCIDENTAL EXPENSES, WE SUGGEST THAT ANY POTENTIAL WARRANTY CLAIM BE DISCUSSED WITH A GATESKATE FACTORY SERVICE CENTER OR AUTHORIZED *TRAILSKATE*™ SERVICE CENTER BEFORE RETURN.)

WHAT IS NOT COVERED

WARRANTY DOES NOT COVER THE PRODUCT OR ANY PART THEREOF WHICH HAS BEEN SUBJECTED TO ACCIDENT, NEGLIGENCE, ABUSE, MISUSE, ALTERATION, FAILURE TO PERFORM MAINTENANCE REQUIRED BY THE OWNER'S MANUAL, OR DAMAGE CAUSED BY ATTEMPTED REPAIR BY PERSONS OTHER THAN AN APPROVED GATESKATE FACTORY SERVICE CENTER OR AUTHORIZED *TRAILSKATE*™ SERVICE CENTER.

PRODUCT REGISTRATION CARD

THE PRODUCT REGISTRATION CARD SHOULD BE COMPLETED IN FULL AND RETURNED TO GATESKATE, INC. RETURN IS NOT A PREREQUISITE TO WARRANTY EFFECTIVENESS BUT WILL ENABLE GATESKATE, INC. TO BETTER SERVE YOU IN THE FUTURE AND TO NOTIFY YOU IN THE UNLIKELY EVENT THAT A PRODUCT SAFETY PROBLEM IS DISCOVERED.

IMPLIED WARRANTIES

THE ONLY EXPRESS WARRANTIES ARE SET OUT HEREIN AND ANY IMPLIED WARRANTIES INCLUDING THE IMPLIED WARRANTIES OF MERCHANTABILITY AND FITNESS FOR A PARTICULAR PURCHASE, ARE LIMITED IN DURATION TO THAT OF THE EXPRESS WARRANTIES. SOME STORES DO NOT ALLOW LIMITATIONS ON HOW LONG ANY IMPLIED WARRANTY LASTS SO THE ABOVE LIMITATION MAY NOT APPLY TO YOU.

LIMITATIONS

TRAILSKATE™ ALL-TERRAIN SKATES USED IN COMMERCIAL ENTERPRISES AND NOT-FOR-PROFIT ORGANIZATIONS ARE SPECIFICALLY EXCLUDED FROM THIS WARRANTY.

NEITHER THE SELLER NOR THE MANUFACTURER SHALL BE LIABLE FOR ANY INJURY, LOSS, OR DAMAGE, DIRECT, INDIRECT, INCIDENTAL OR CONSEQUENTIAL, ARISING OUT OF THE USE OF OR THE INABILITY TO USE THE PRODUCT. BEFORE USING, USER SHALL DETERMINE THE SUITABILITY OF THE PRODUCT FOR HIS OR HER INTENDED USE, AND USER ASSUMES ALL RISK AND LIABILITY WHATSOEVER IN CONNECTION THEREWITH.

SOME STATES DO NOT ALLOW THE EXCLUSION OR LIMITATION OF CONSEQUENTIAL OR INCIDENTAL DAMAGES. THIS WARRANTY GIVES YOU SPECIFIC LEGAL RIGHTS AND YOU MAY HAVE OTHER RIGHTS, WHICH VARY FROM STATE TO STATE.

Gateskate, Inc.
2655 Einstein Avenue, Richland WA 99352
(509) 371-0726
www.gateskate.com

copyright © 2001 GateSkate, Inc. – All rights reserved.
GateSkate™ and the GateSkate Logo are trademarks of GateSkate, Inc. TrailSkate™ and the TrailSkate Logo are trademarks of GateSkate, Inc. All other product names and/or marks are trademarks of their respective owners.